

Belt fasteners

V.A.V. also supplies the necessary belt fasteners for the assembly of the elevator belts. In various different versions, suitable for all kinds of belts.

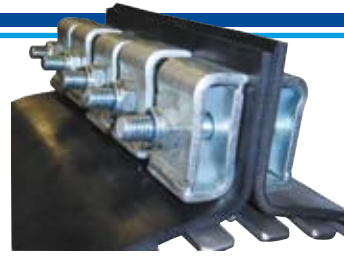

Belt fastener models 1, 2 and 3

Parameters models 1, 2 and 3 (in mm)			
	A	B	max. belt load
Model 1	62	32	40 kg/cm
Model 2	68	32	80 kg/cm
Model 3	68	32	125 kg/cm

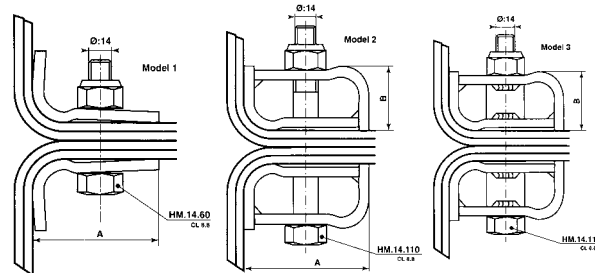

Belt fasteners, Speedy model

3-part belt fastener made of cast iron or bronze, standard width 50 mm, suitable for maximum belt loads of 80 kg/cm.

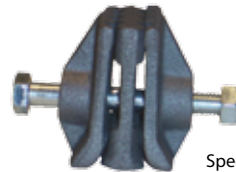

Speedy type belt fasteners

Assembly

Example of the assembly of 4 belt fasteners for belt widths between 200 and 230 cm.

The distance between the belt fasteners may be somewhere between 50 and 60 mm.

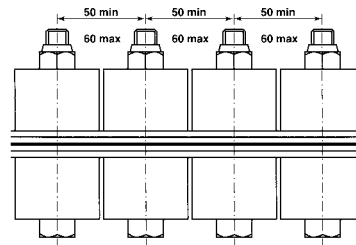

Belt clamps

Belt clamps offer an alternative to the belt fasteners. They are manufactured to your specifications. 2 models are available.

Model A:

For light to average applications.

Model B:

Belt clamps with a wedge-shaped adaptor to guide the belt over the pulley in conjunction with more demanding applications.

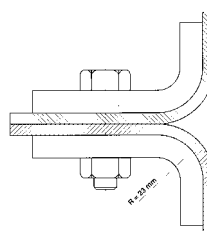

Model A

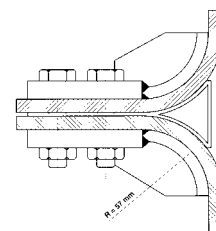

Model B

